

Furnitures accessories

CAMDEXPORT

Required tools for installation and adjustment

- Exagonal key 3 mm
- Screwdriver PH3

Stopper installation

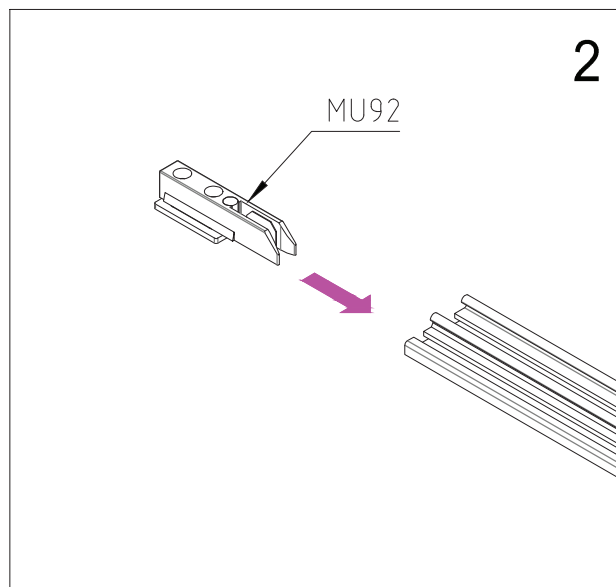
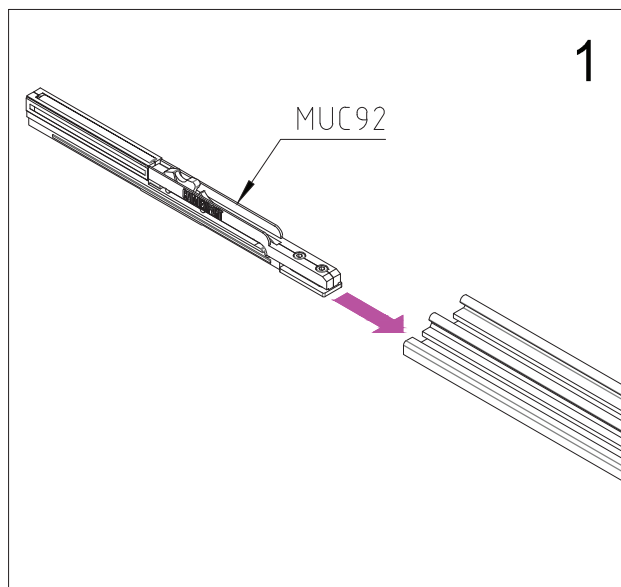

1 - Insert the soft closing stopper in the upper rail, being sure to keep the fixing plates point towards the central part of the track.

2 - Insert the stopper in the upper rail.

Mounting rails with clip / quick hooking

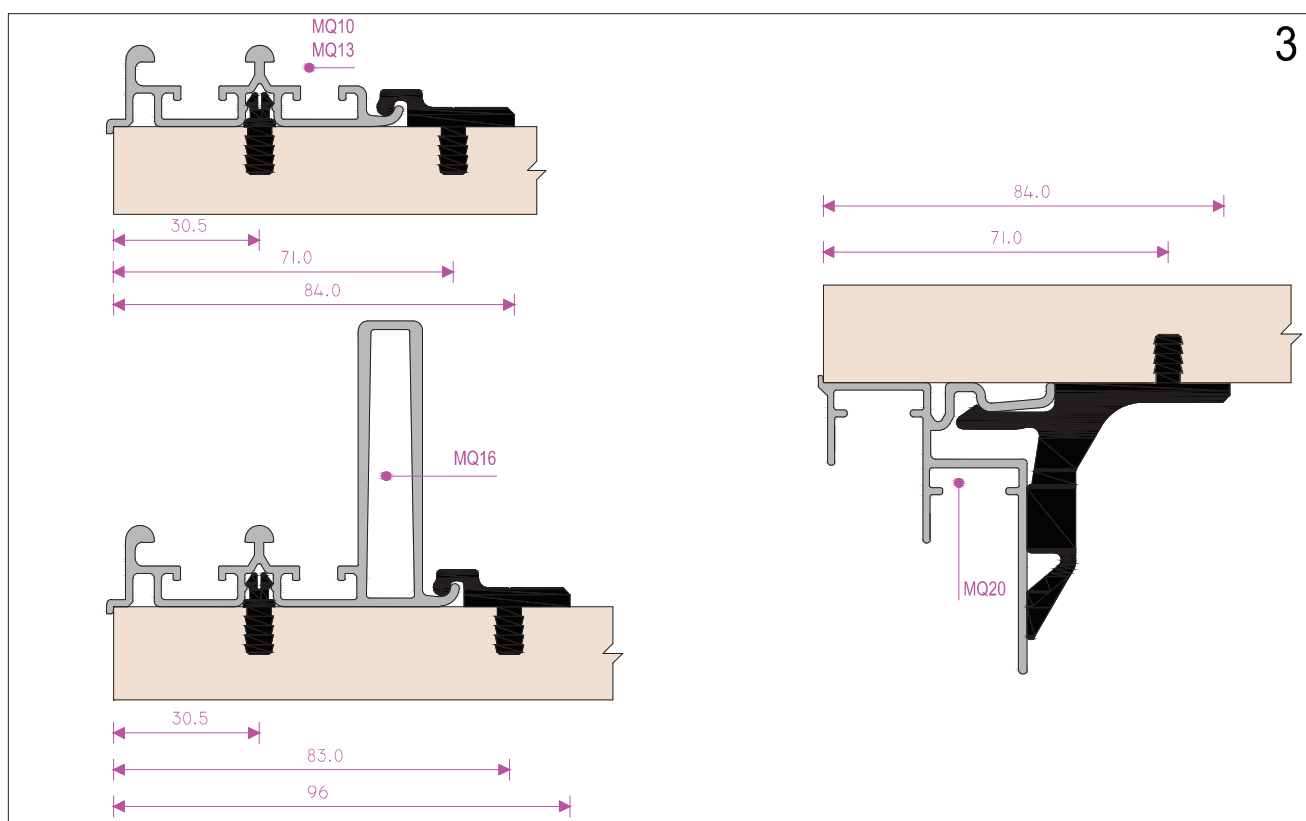

3 - After mounting Master Quick clip , hook the rails.

Stopper installation

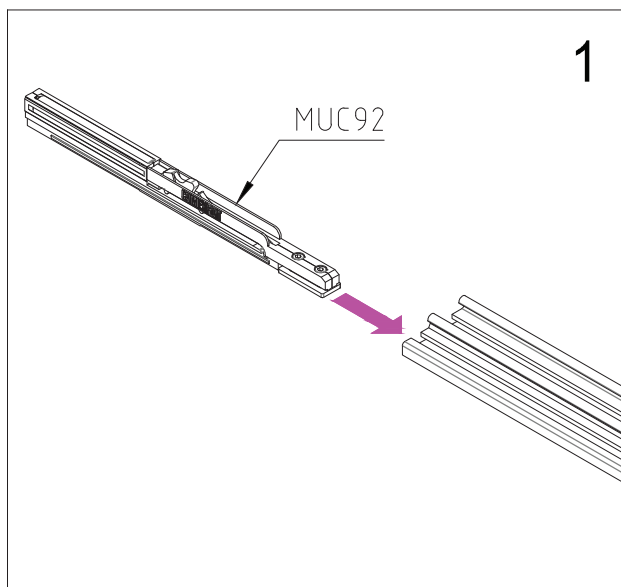

1 - Insert the soft closing stopper in the upper rail, being sure to keep the fixing plates point towards the central part of the track.

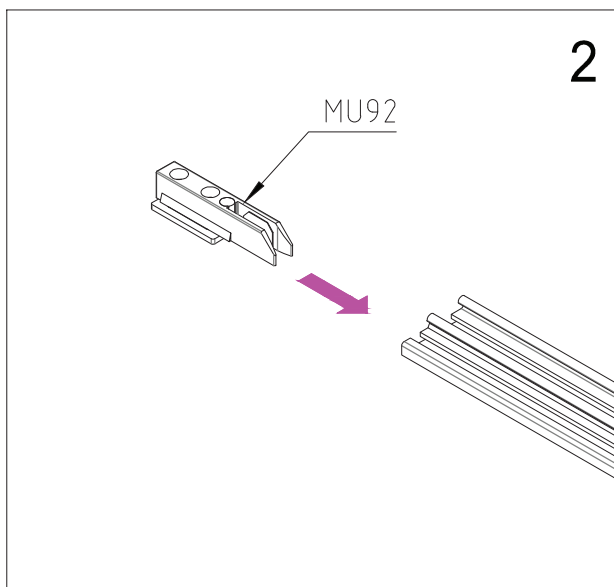

2 - Insert the stopper in the upper rail.

Mounting rails with screws

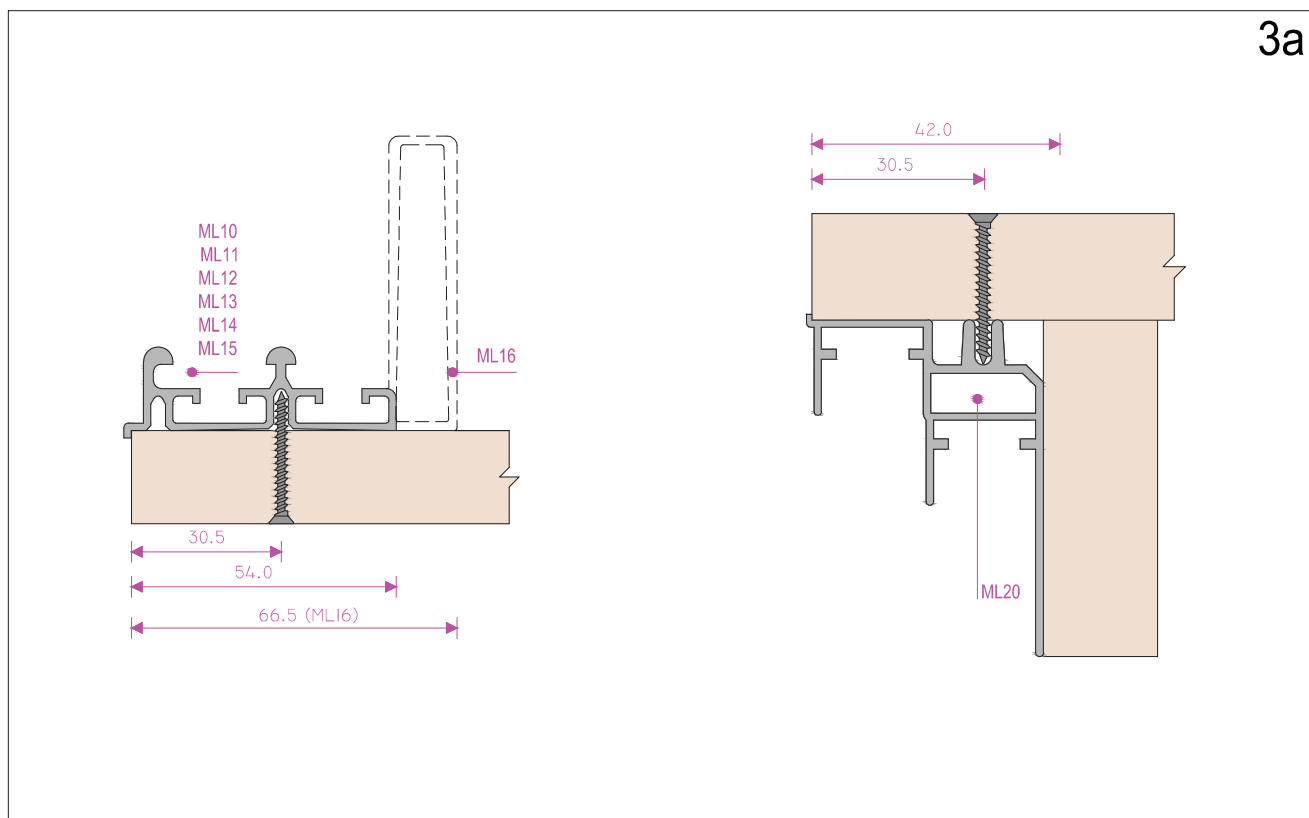

3a - Fix the rails on the furniture

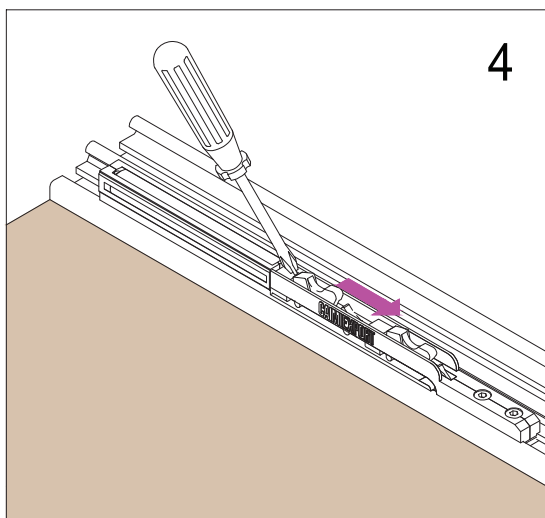

4 - Open the cursor arming the back system

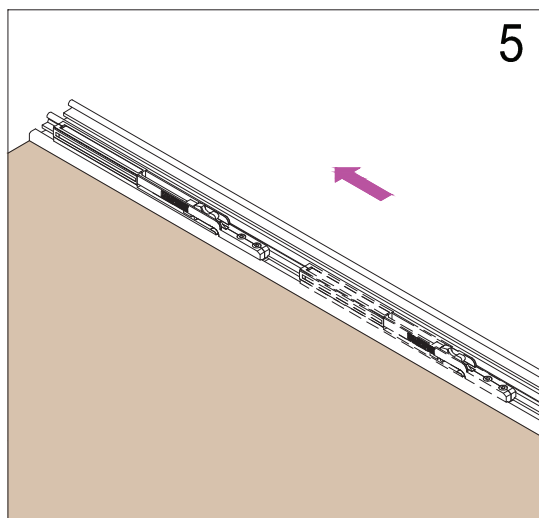

5 - Move all the stoppers to the shoulders of the cabinet, leaving the central part of the tracks free to facilitate the mounting of the doors

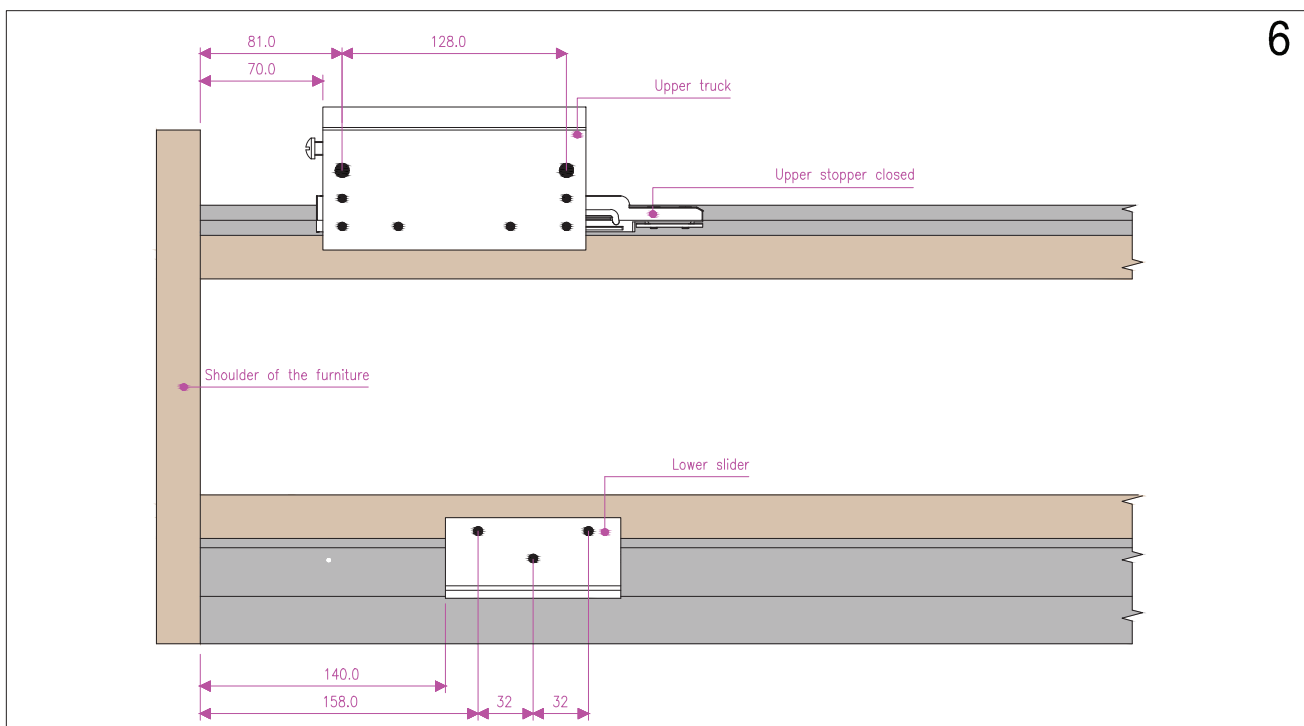

6 - Dimensions recommended for drilling the doors for trucks and sliders

Internal truck of the door

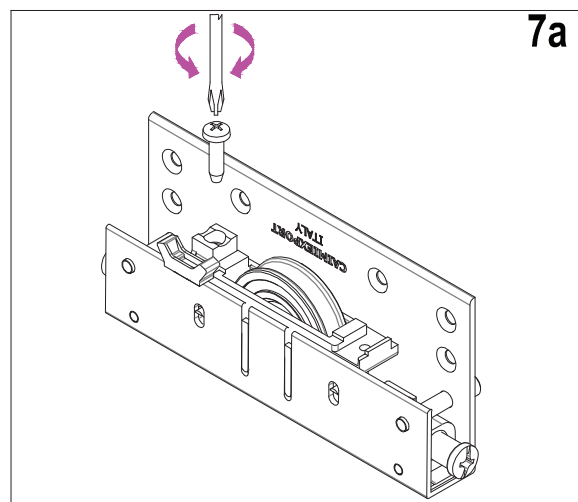
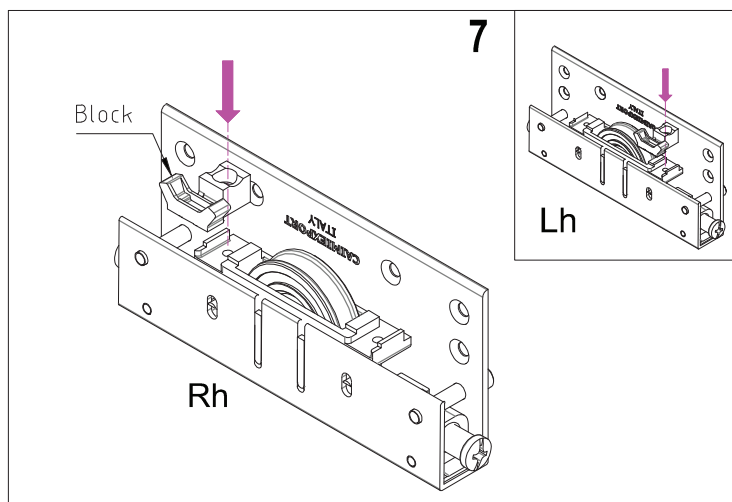

7 - Place the block into the seat on the wheel holder

7a - Fix the block to the wheel holder of the truck with a self tapping screw.

External truck of the door

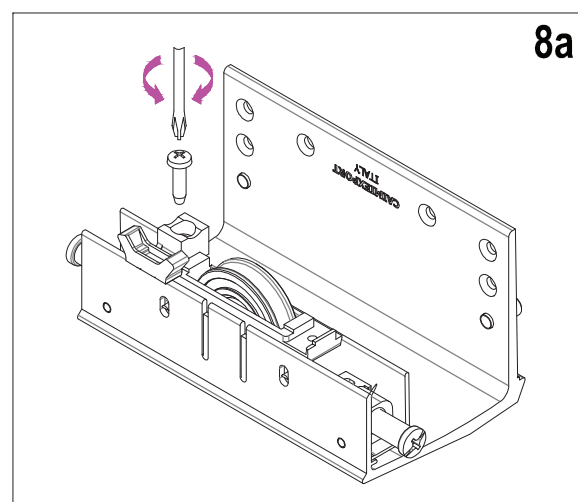
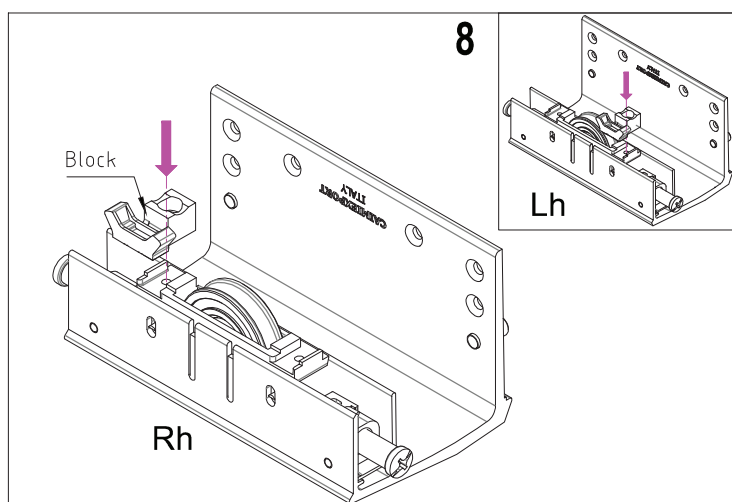

8 - Place the block into the seat on the wheel holder

8a - Fix the block to the wheel holder of the truck with a self tapping screw

NO

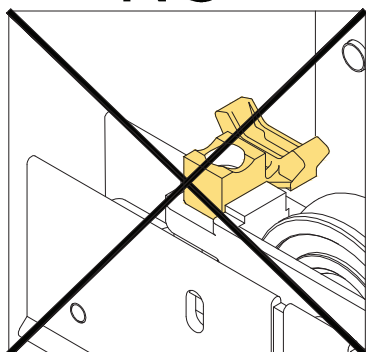

YES

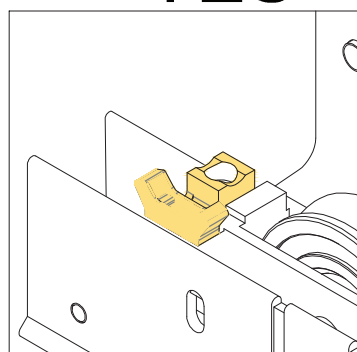

ATTENTION to the mounting direction of the block

Wardrobes with soft closing and soft opening

Position of the block for 2 doors wardrobe

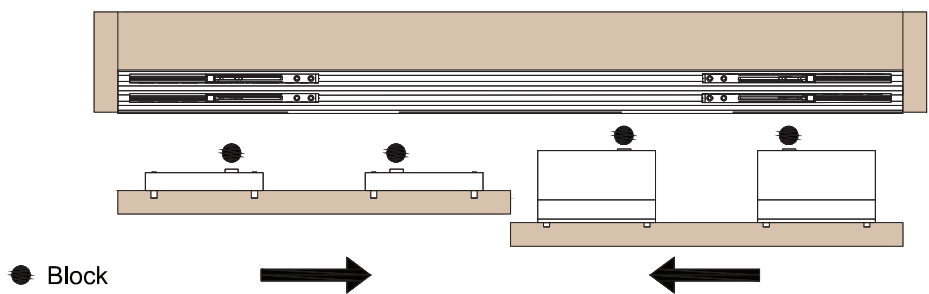

Position of the block for the 3 doors wardrobe
external door opening to the left

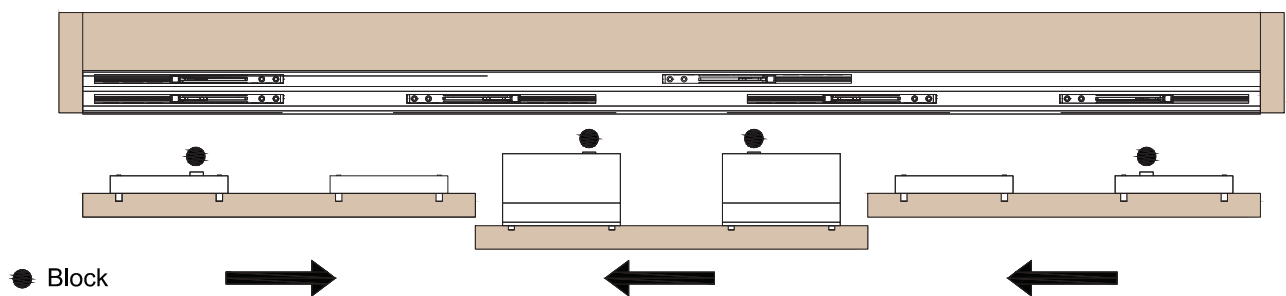

Position of the block for the 3 doors wardrobe
external door opening to the right

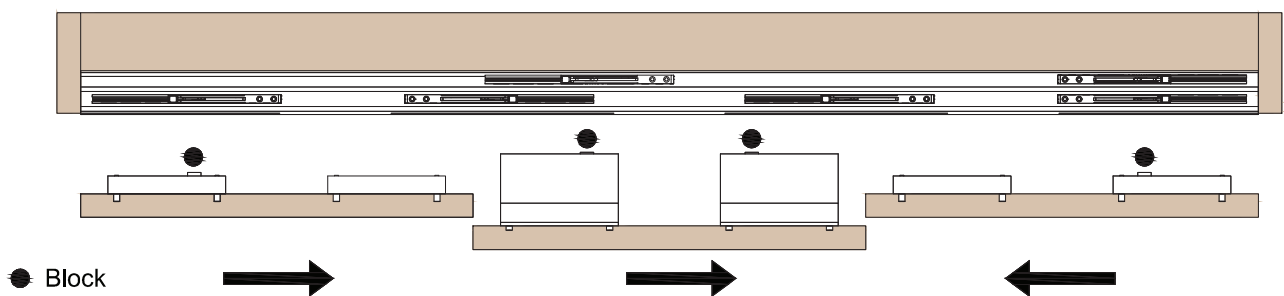

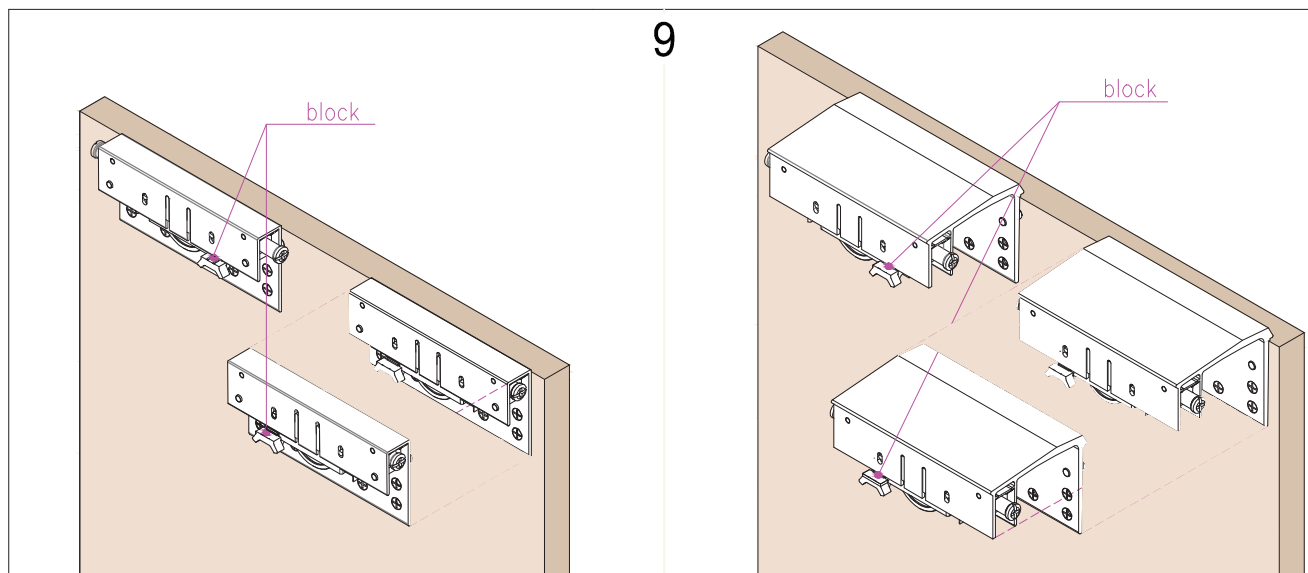

9 - Mount the truck on the doors, keeping the block on the internal door side

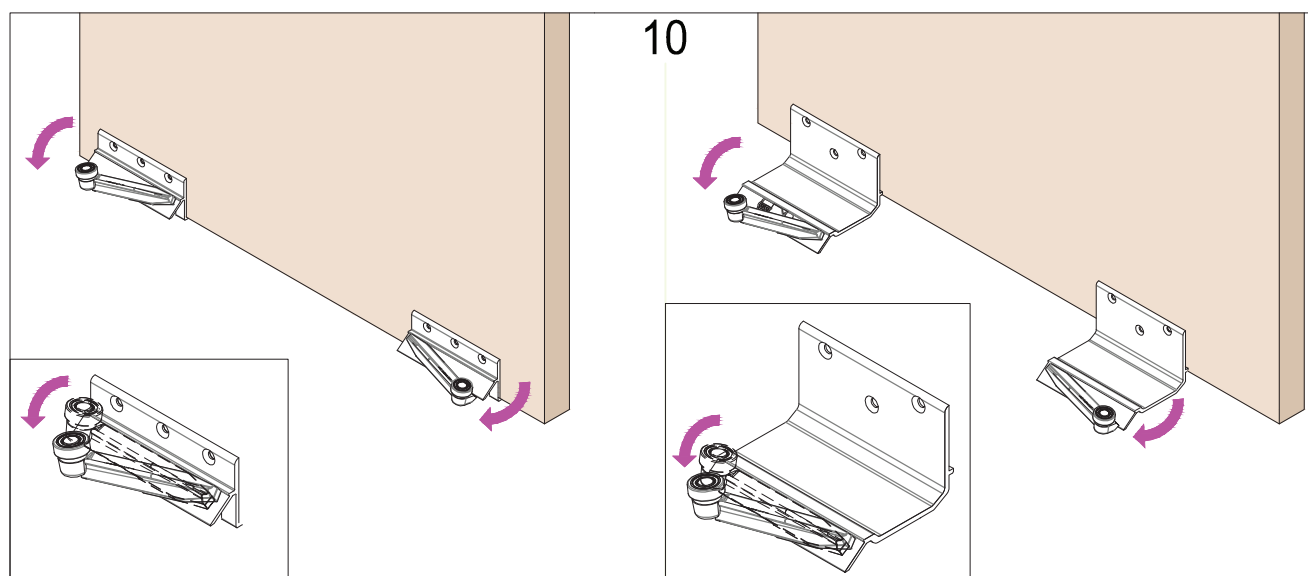

10 - Fix the lower slider turning the arm outward

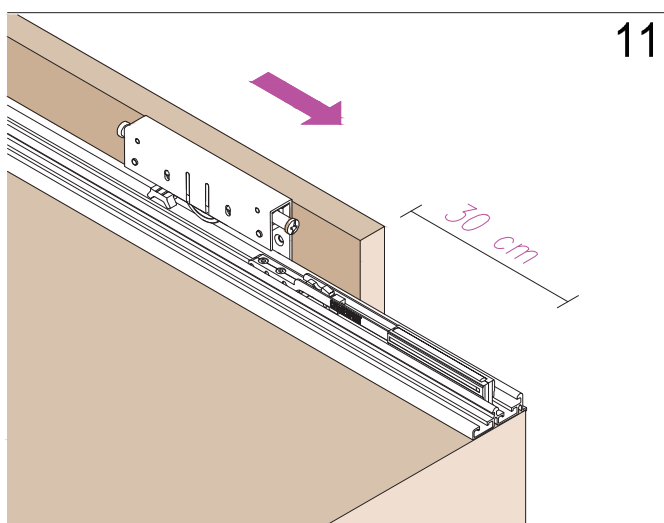

11 - Place the internal door on the upper rail, with about 30cm from the edge of the cabinet, making sure that the truck do not overlap the stoppers

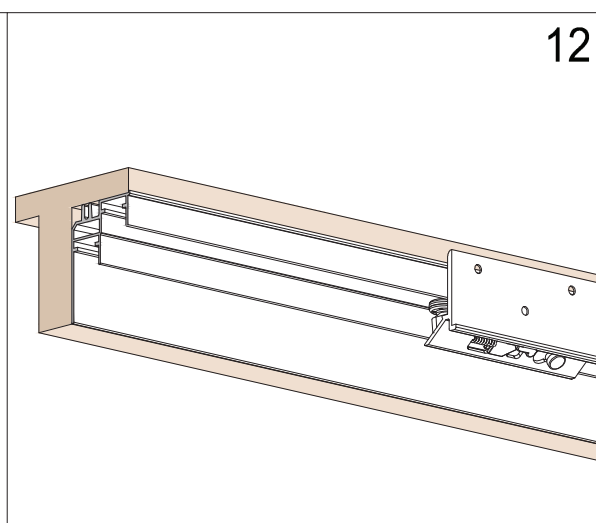

12 - Block the door placing the lower side on the rail and press lightly until to hear the click of the previously open arms

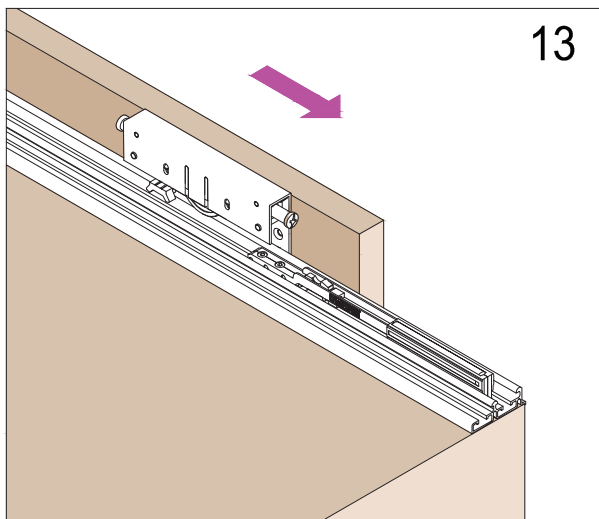

13 - Slide the door to the cabinet side freeing up the space on which will be mounted the external door.

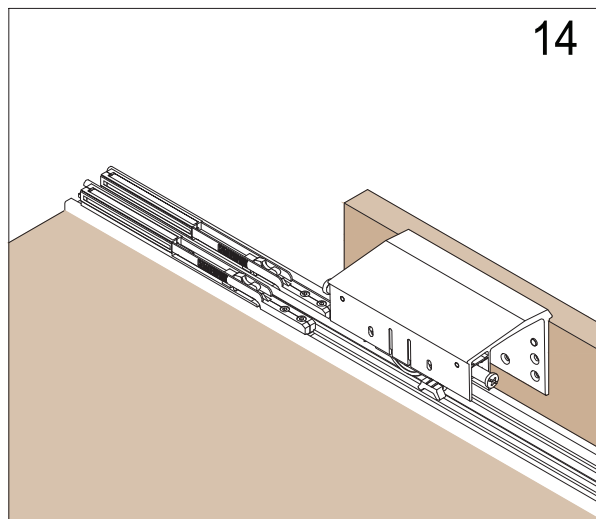

14 - Place the external door on the wardrobe structure.

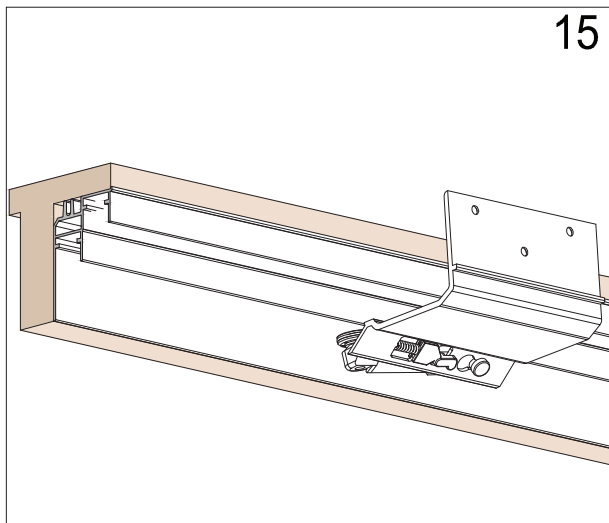

15 -Block the door placing the lower side on the rail and press lightly until to hear the click of the previously open arms

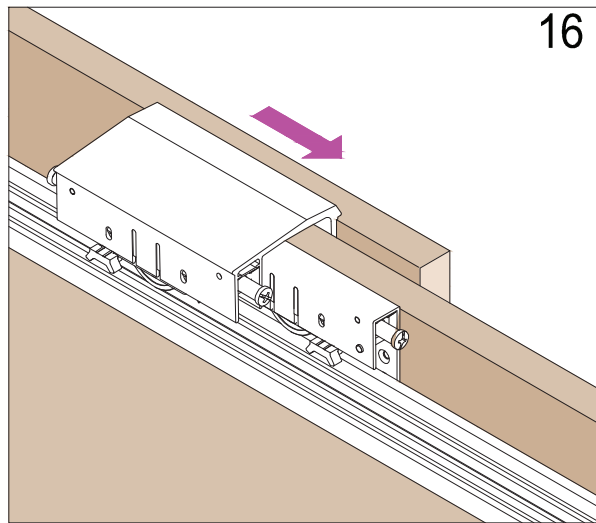

16 - In the case of cabinets with 3 doors, slide the door toward the outside shoulder of the cabinet by overlaying the internal one. After this, repeat steps 12/11/13

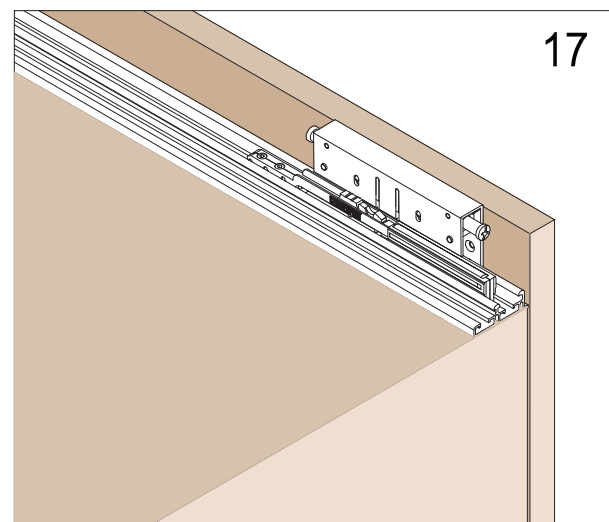

17 - Slide the first panel until it locks with the upper stopper.

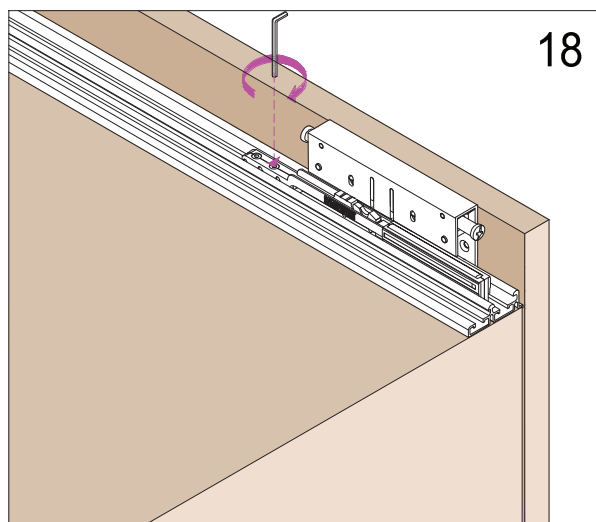

18 -After moving doors in their correct position, block the upper stopper with a 3 mm key

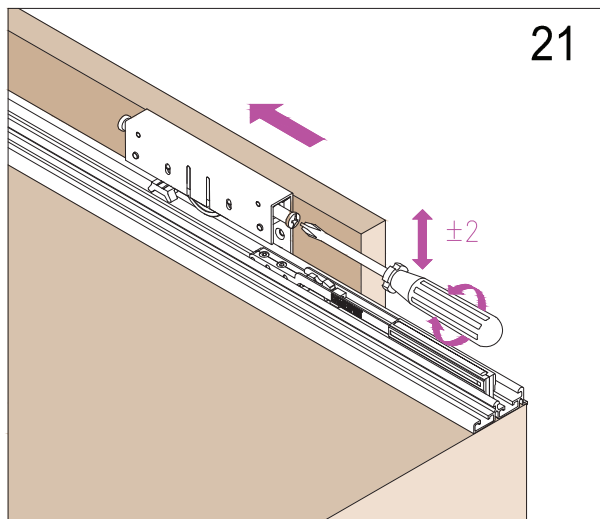

21 - After releasing the door stopper, adjust the vertical acting with a screwdriver on one of the two adjusting screws on the truck

Assembly dust-cover

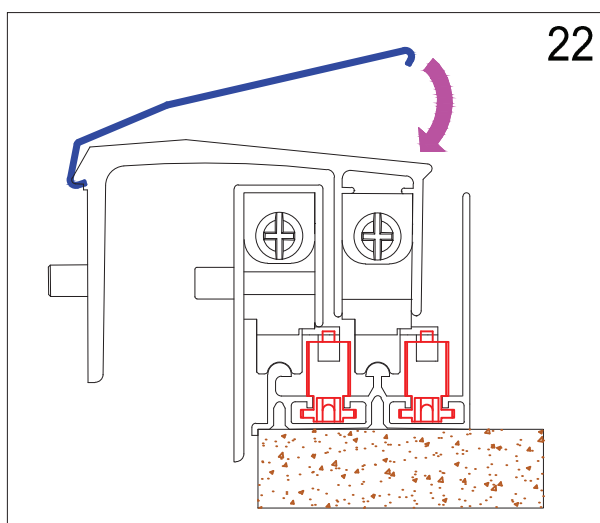

22 - Place the dust cover on the front side of the external door

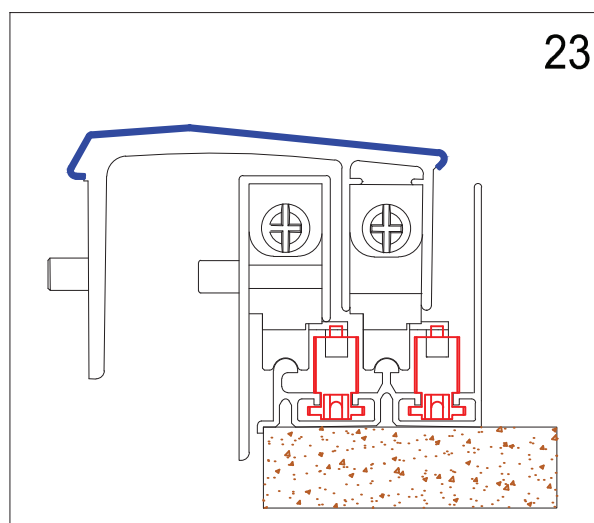

23 - With a little pressure put the dust on the back side of the truck