



Silent Aluflex 40 Sliding Door System  
For exquisite rooms and furniture

## Silent Aluflex 40 sliding door system: A wealth of options for people who want the best

Escape the mundane and discover something special: Unusual inspirations and surprising solutions to your space requirements – the Silent Aluflex 40 can do all of this. Let us tempt you with the ideas on the following pages. Let yourself be swept along by the surprising solutions for kitchens, dining rooms, bathrooms, offices and hallways. Discover new storage space and uses for slopes, recesses and stairs that you never even dreamed of! Make more of your rooms and your furniture – with Silent Aluflex 40 and personal advice from your joiner/cabinet maker.

### It is a question of style

Be it a living room in an old high-ceilinged city building, a cosy country home full of nooks and crannies in an idyllic spot, or a modern building – individual sliding doors that are made to measure for the space that you have available can be installed up to a height of 2.5 metres and as wide as you like. The best shape, design and materials for your situation are decided by your own personal lifestyle.

### The convenience that you deserve

Unique living and operating convenience using well-engineered hardware; Large sliding doors are particularly impressive because of their maximum running safety and gentle, reliable closing – over the course of many years.

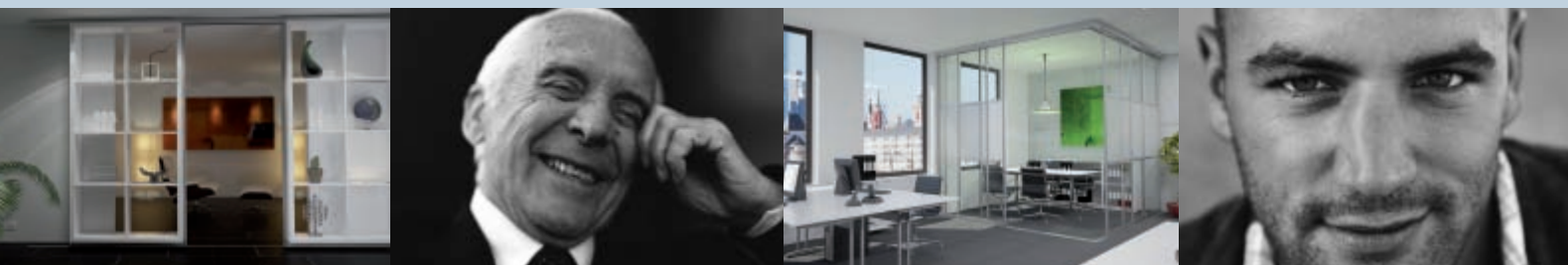

# Contents

Livingrooms	Pages 4–6
Bathroom access doors	Pages 7–10
Use of recesses	Page 11
Equipment solutions	Pages 12–17
Shelves for sliding	Page 18
Offices	Pages 19–21
Planning tips	Pages 22–23

Solutions for rooms  
e.g. dining room and kitchen

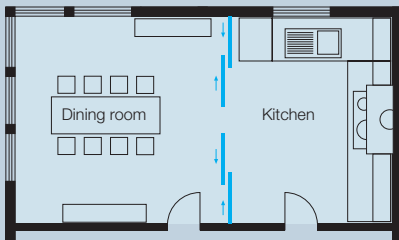

Solutions for doors  
e.g. bathroom access

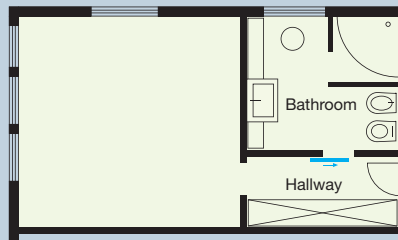

Equipment solutions  
Walk-in wardrobe

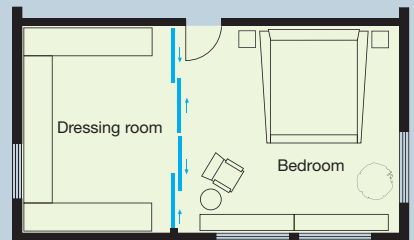

Solutions for furniture  
e.g. wardrobe

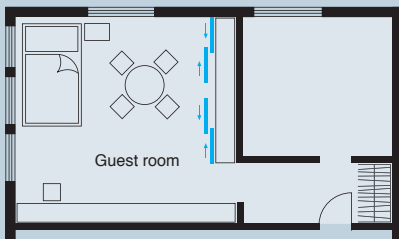

Solutions for rooms with slopes  
e.g. bedroom

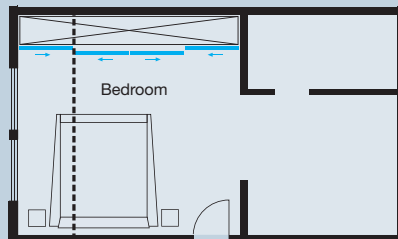

Solutions for recesses  
e.g. office archive

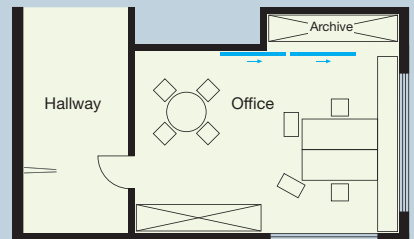

# From lobby to boudoir

Grant yourself the luxury of designing your living space individually, in any way you please. Elegant sliding solutions allow you to conveniently transform your living and dining rooms into a spacious room for family celebrations, or create a cosy corner for a glass of Burgundy on your own or with a companion in a single movement.



The glued-on running track protects the existing floor covering.

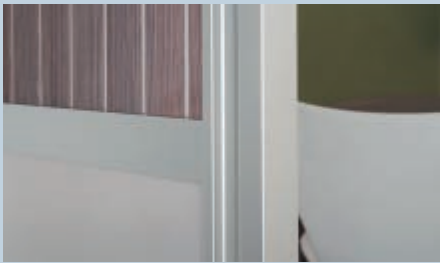

Acrylic glass with veneer attached at both sides – stripes cut into the veneer: The customised door panel is complete.

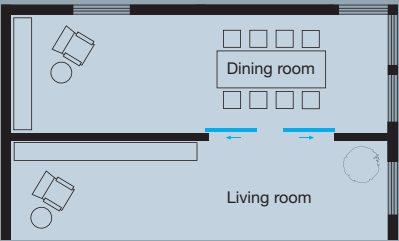

## VERSION

- H 2,400 mm x W 2,000 mm
- Ceiling/floor installation
- 2 door leaves
- Frame colour: Silver coloured, anodized E6/EV1
- Single running and guide track
- Running track glued on
- 2 bar profiles per door leaf
- Soft closing mechanism



## A matter of taste

The candlelight dinner for your silver wedding, the Sunday family brunch or just pasta with friends – the kitchen, the dining area and good living simply belong together as far as you are concerned. And also as far as we are concerned. With a flexible connection between dining room and kitchen.



Frame colour (frame colour: Silver coloured, anodized E6/EV1) and the root design panels blend ideally into the room.



The double guide track allows the door to be installed beneath the existing soffit.

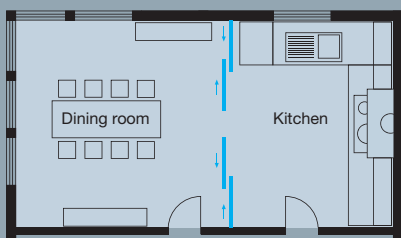

### VERSION

- H 2,500 mm x W 3,000 mm
- Ceiling/floor installation
- 4 door leaves
- Frame colour: Silver coloured, anodized E6/EV1
- Double running and guide track
- Running track glued on
- Door stop
- Brush seal
- Soft closing mechanism

## Modern food storage

Be it the best Italian olive oil, mum's home-made marmalade or simply a bag of flour – you really can keep an eye on everything in this individually designed pantry. And put them out of sight when you silently close the sliding door behind you.



### Tips

for making  
use of storage  
space

No fear of heavy items in the pantry! Special heavy-duty extensions with a high load bearing capacity are available for storing drinks, for example.

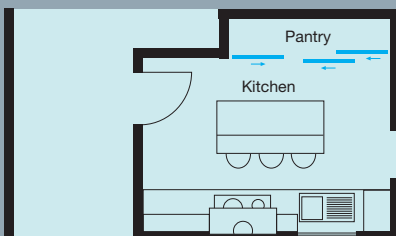
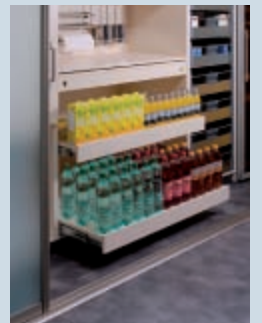

### VERSION

- H 2,400 mm x W 3,000 mm
- Ceiling/floor installation
- 3 door leaves
- Frame colour: Silver coloured, anodized E6/EV1
- Double running and guide track
- Running track glued on
- Door stop (centre)
- Soft closing mechanism

## Pure relaxation

Every day begins and ends in a better way in ambience like this. And you can combine the bedroom and the bathroom into a wellness area whenever you like. Sliding doors are the solution – at any time of day.



Extremely quiet running properties provide additional living comfort.



Several panels in one door leaf – not a problem with subdividing bar profiles.



### VERSION

- H 2,400 mm x W 2,200 mm
- Front overlay mounting
- 2 door leaves
- Frame colour: Silver coloured, anodized E6/EV1
- Running track glued on
- 2 bar profiles per door leaf
- Soft closing mechanism



Access without threshold

# Child's play

Sliding doors are easier to open and close than hinged doors. An everyday luxury for everyone, and a necessity for people with restricted mobility.



Ideal for finishing off the guide track: Cover caps at the sides.



Consistently barrier-free: Running track recessed in the floor.

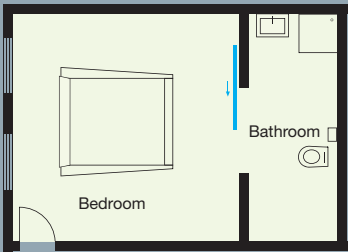

## VERSION

- H 2,000 mm x W 1,000 mm
- Front overlay mounting
- 1 door leaf
- Frame colour: Silver coloured, anodized E6/EV1

- Single running and guide track
- Recess mounted running track
- Soft closing mechanism



# Good morning, nature

When you turn the bathroom into an oasis of well-being, don't forget the plants: Real leaves and stalks embedded in acrylic glass create emphasis – and make every sliding door an "eye catcher".



Independent of the room height: Top guide track overlay mounted to the wall.



Determining the effect of light and space: Panels made from natural materials.

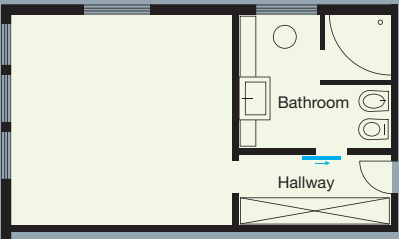

## VERSION

- H 2,000 mm x W 900 mm
- Front overlay mounting
- 1 door leaf
- Frame colour: Silver coloured, anodized E6/EV
- Single running and guide track
- Running track glued on
- Soft closing mechanism

# Start the day at your peak

Doing something that is good for yourself, relaxing, engaging in a little sporting activity. It is useful if these areas can be combined using a successful sliding door solution and also be separated again.

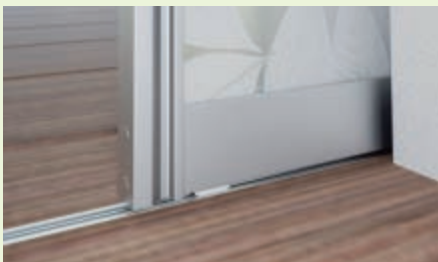

Stylish and convenient: The recess mounted running track.



The door leaves simply disappear in wall cavities.

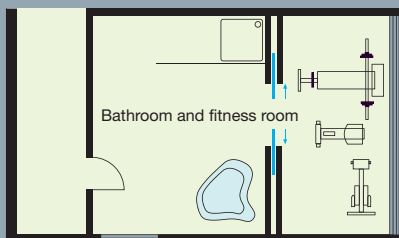

## VERSION

- H 2,500 mm x W 2,200 mm
- Ceiling/floor installation
- 2 door leaves
- Frame colour: Silver coloured, anodized E6/EV1
- Single running and guide track
- Recess mounted running track
- Soft closing mechanism

Recess next to the pool

## Just like being on vacation

It's done. Take a deep breath, dive in, leave the daily routine behind you and enjoy the peace and quiet and the water. No sign of towels, your inflatable duck or whatever else you like to have around the pool. There is plenty of room for them in the recess behind the sliding door.

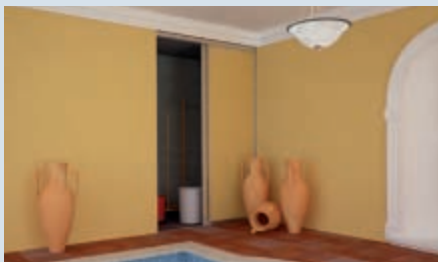

Concealed, but ready to hand at all times:  
Utensils in the wall recess.

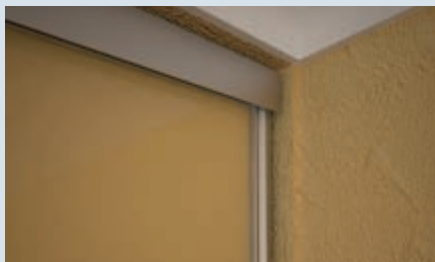

Uniform appearance: The panels match the  
colour of the wall.



No need to drill holes in the floor tiles:  
The running track is simply glued on.

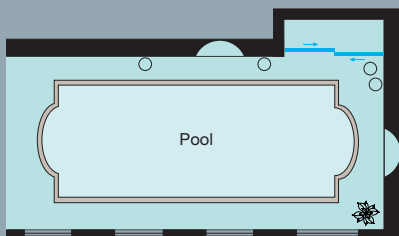

### VERSION

- H 2,500 mm x W 2,300 mm
- Ceiling/floor installation
- 2 door leaves
- Frame colour: Silver coloured, anodized E6/EV1
- Double running and guide track
- Running track glued on
- Soft closing mechanism



# For rooms with character

Thinking around the corner: Sliding doors can cope with any room situation.  
Let yourself be inspired!

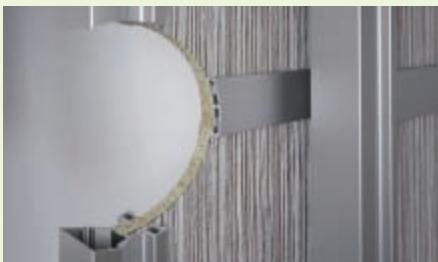

Decorative bar profiles for simply gluing on.

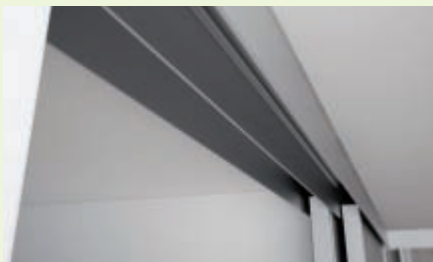

Made to measure: The top guide track runs along the ceiling.

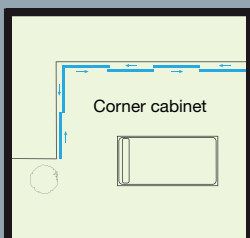

## VERSION

- System 1 H 2,450 x W 1,800
- System 2 H 2,450 x W 3,600
- Ceiling/floor installation
- 2 and 4 door leaves
- Frame colour: Silver coloured, anodized E6/EV1
- Double running and guide track
- Running track glued on
- Brush seal and soft closing mechanism
- Door stop
- 2 decorative bar profiles per door leaf



# The enjoyment of choosing your clothes

Still a cupboard, or already a room? Owners of a walk-in dressing room experience the enjoyment of choosing and trying on clothes every day.

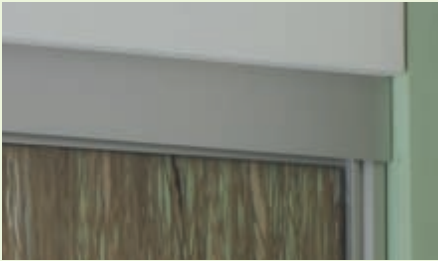

The guide track orients itself exactly to the structural situation.



These panels with field grass combine privacy with aesthetic appeal.



## Tip:

For utilising storage space in walk-in wardrobes

Make full use of the height of your walk-in wardrobe – with a wardrobe lift.

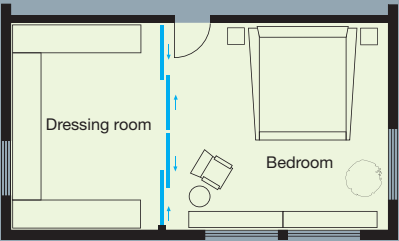

## VERSION

- H 2,400 mm x W 4,000 mm
- Ceiling / floor installation
- 4 door leaves
- Frame colour: Silver coloured, anodized E6/EV1
- Double running and guide track
- Running track glued on
- Brush seal
- Soft closing mechanism

## Made to measure

A man's kingdom is his wardrobe. Sliding doors open up new perspectives for all people who appreciate order and organisation just as much as their clothes and shoes.



### Tip:

For utilising storage space inside the cabinet

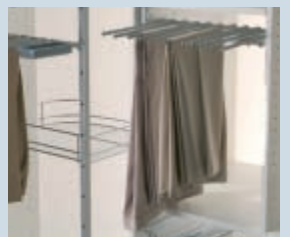

Easy access to clothing items:  
Extending baskets and trouser racks make it possible.



Bar profiles connect the different panels.

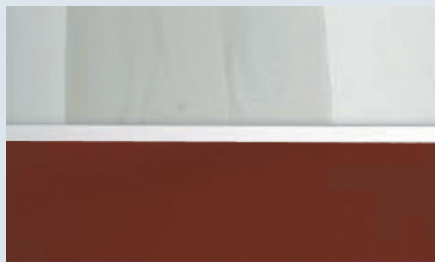

The transition from transparent to coloured material provides variety.

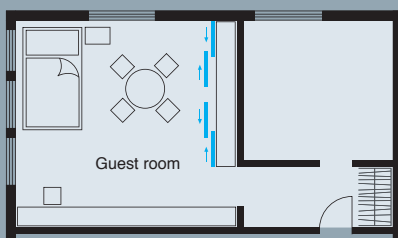

### VERSION

- H 2,000 mm x W 2,800 mm
- Infront
- 4 door leaves
- Frame colour: Silver coloured, anodized E6/EV1
- Double running and guide track
- Running track recess mounted in the floor
- Brush seal
- Soft closing mechanism
- 2 bar profiles per door leaf

## Practical elegance

Happy to be living in the attic room? You bet. The walk-in wardrobe is something that even the coolest customer will rave about. And: There is room everywhere for small surprises.



Door leaves with partial or complete slopes make maximum use of sloping ceilings.



The running track disappears into the floor.



Bar profiles can also be glued on as a decorative option.

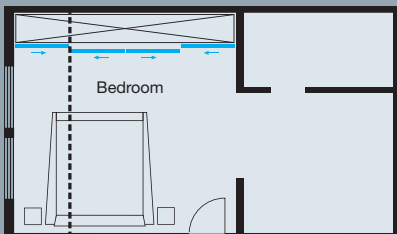

### VERSION

- H 2,300 mm x W 3,000 mm
- Inset front mounting
- Individual solution with door leaves, one with a partial slope and one with a complete slope
- Frame colour: Silver coloured, anodized E6/EV1
- Double running and guide track
- Recess mounted running track
- Soft closing mechanism and brush seal
- 2 decorative bar profiles – for one door leaf

## Sloping ideas

Sloping is charming – and has enormous potential. Silent Aluflex 40 transforms the jamb beneath the ceiling into useful storage space.



A panel provides a seamless connection to the ceiling slope.



An adjustable bracket allows the top guide track to be adapted to any ceiling slope.

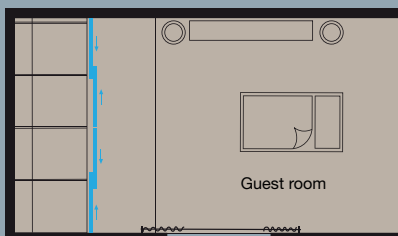

### VERSION

- H 1,400 mm x W 4,400 mm
- Ceiling/floor installation
- 4 door leaves
- Frame colour: Silver coloured, anodized E6/EV1
- Double running and guide track
- Running track glued on
- Brush seal
- Door stop
- Ceiling slope angle
- Soft closing mechanism



## Useful additional space

The property developers of yesteryear turned stairways into a place of splendid prestige. Nowadays, a well-placed sliding door under the stairs can conjure up a practical storage space.



Precisely fitted sloping door leaves fill the area beneath the stairs with millimetre accuracy.



In places where the slope will not allow a guide track to be used, tracks on shelves come into play.

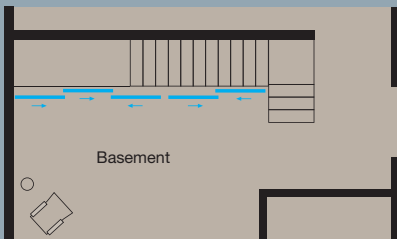

### VERSION

- H 2,500 mm x W 4,000 mm
- Ceiling/floor installation
- Individual variant
- Frame colour: Silver coloured, anodized E6/EV1
- Double running and guide track
- Running track glued on
- Brush seal
- Door stop

# Expert knowledge

Books, books and more books. A mobile shelf allows you to transform your private library into a room partition. Tasteful and unusual.



A splendid idea: A sliding shelf made from lightweight panels.



The top edge of the shelf terminates with the guide track.



## VERSION

- H 2,500 mm x W 3,000 mm
- Ceiling/floor installation
- 2 door leaves
- Frame colour: Silver coloured, anodized E6/EV1
- Single running and guide track
- Running track glued on
- Soft closing mechanism

# Concentrated creativity

Developing shared ideas, discussing, enjoying success. Modern working environments require new office design solutions. Sliding doors provide the spatial flexibility that is needed, and help you to concentrate.

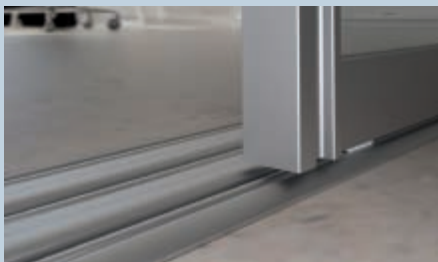

Triple running and guide track for extremely space-saving solutions.



Useful detail: Brushes on the side profiles provide protection from dust.

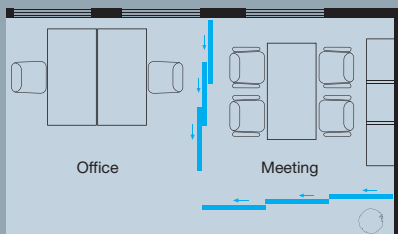

## VERSION

- H 2,500 x W 3,000 (2 systems)
- Ceiling/floor installation
- Individual variant (2 x 3 door leaves)
- Frame colour: Silver coloured, anodized E6/EV1
- Triple running and guide track
- Running track glued on
- Brush seal
- Door stop
- Soft closing mechanism
- 2 bar profiles per door leaf

## Just slide it open

A fresh pot of coffee has determined the success of many meetings.  
Not a bad idea to have the kitchen close at hand – just waiting to  
be used behind a sliding wall.



Four doors, countless possibilities – for  
additional storage space, for example.



Handle profiles provide a convenient way of  
opening and closing.

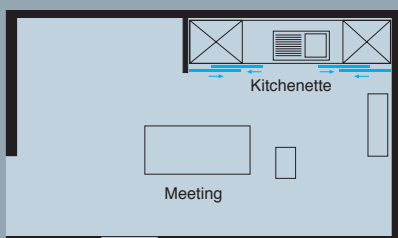

### VERSION

- H 2,500 mm x W 4,800 mm
- Ceiling/floor installation
- 4 door leaves
- Frame colour: Silver coloured, anodized E6/EV1
- Double running and guide track
- Recess mounted running track
- Brush seal
- Door stop
- Soft closing mechanism
- 2 bar profiles per door leaf



# Utilising space, in the tiniest recesses

Unusual layout plans often conceal unused recesses and corners. A sliding solution turns them into an archive, for example, in no time at all. For doctor's surgeries, lawyer's offices, executive offices and much more.



The colour-coordinated panel highlights the office design.

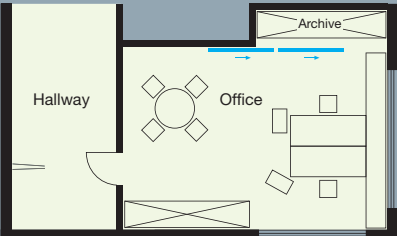

## VERSION

- H 2,100 mm x W 2,000 mm
- Front overlay mounting
- 2 door leaves
- Frame colour: Silver coloured, anodized E6/EV1
- Single running and guide track
- Running track glued on
- Soft closing mechanism

# Sliding door systems with Silent Aluflex 40 have many advantages

Your sliding door systems are equipped with maximum running and operating convenience so that you can continue to enjoy them for many years.

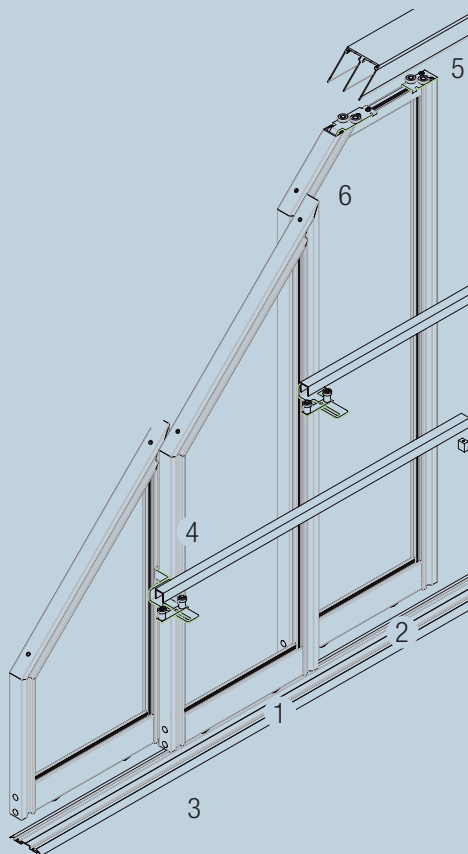

- 1 The bottom rollers with their soft plastic covering are impressive because of their gentle, quiet running action, even with heavy door leaves weighing up to 40 kg.
- 2 The spring-mounted running gears make doors easy to unhook and suspend, and keep installation costs down.
- 3 The flat, concave running tracks are extremely easy to clean and run over with wheels and castors.
- 4 The stable lateral frame profile can hold panel materials made from glass, acrylic, laminate and wood.
- 5 The Häfele Smuso soft closing system for automatic, gentle door closing protects hands from being trapped.
- 6 Every ceiling slope angle is easy to adapt to using flexible jointed profiles.

## The most important information:

- Maximum system height: 2500 mm
- Maximum system width: No restriction, depends on number of leaves
- Door leaf width: 500 to 1,500 mm
- Door leaf weight, including panels: max. 40 kg
- Panel thickness: Without clip-on profile 8 mm, with clip-on profile 6 mm

## Tips for easy planning

### 1. Measure the dimensions:

- Measure internal height and width of the entire wall opening.
- Calculate number of door leaves: Widths of 500–1,500 mm.

### 2. Define special features:

- Measure ceiling slope angle
- Should the top track be beneath the ceiling or in front of the wall?
- Should the bottom track be recess mounted in the floor covering or glued to the floor?

### 3. Select panels for the doors:

- Transparent material for additional light?
- Or decorated panels for more privacy?
- Or rather a mixture of materials with separating bar profiles?

### 4. Choose door design:

- Use adhesive decorative bar profiles when designing large doors.
- Separating bar profiles in the frame profile allow several decorative panels to be effectively mixed.
- Dividing up the door area with bar profiles increases the amount of design freedom.

Your expert interior fitting company would be pleased to give you advice about designs and colour schemes.

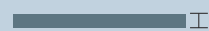

Door thickness  
with single track: 41 mm



Door thickness  
with double track: 81 mm



Door thickness  
with triple track: 119 mm

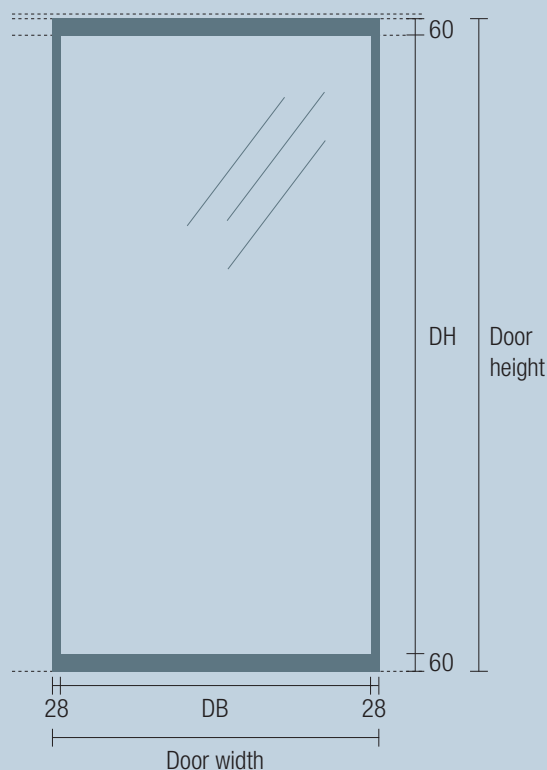

DH = visible decoration height  
DB = visible decoration width

Europe

Headquaters Germany

Häfele GmbH & Co KG  
72202 Nagold  
Phone +49 (0)74 52 / 95-0  
Fax +49 (0)74 52 / 95-2 00  
info@haefe.de

Austria

Häfele Austria GmbH  
5322 Hof bei Salzburg  
Phone +43 (0)62 29 / 3 90 39-0  
Fax +43 (0)62 29 / 3 90 39-30  
info@haefe.at

Belgium

Häfele Belgium N. V.  
9240 Zele  
Phone +32 (0)52 / 45 01 14  
Fax +32 (0)52 / 45 01 51  
info@haefe.be

Croatia

Häfele GmbH & Co KG  
Representative in Kroatien  
10090 Zagreb  
Phone +38 51 / 3 43 57 40  
Fax +38 51 / 3 43 57 41  
info-croatia@haefe.com

Denmark

Häfele Danmark A/S  
7800 Skive  
Phone +45 97 / 51 15 22  
Fax +45 97 / 51 12 13  
info@haefe.dk

Finland

Häfele GmbH & Co KG  
Sivuliike Suomesa  
15200 Lahti  
Phone +3 58 (0)3 / 8 77 77-0  
Fax +3 58 (0)3 / 8 77 77-88  
info@haefe.fi

France

Häfele France s.à.r.l.  
95157 Taverny Cédex  
Phone +33 (0)1 / 30 40 54 50  
Fax +33 (0)1 / 30 40 54 61  
info@haefe.fr

Great Britain

Häfele U.K. Ltd.  
Rugby, Warks. CV211RD  
Phone +44 (0)17 88 / 54 20 20  
Fax +44 (0)17 88 / 54 44 40  
info@haefe.co.uk

Greece

Häfele GmbH & Co KG  
Information Office  
15124 Maroussi  
Phone +30 2 10 / 6 17 95 44  
Fax +30 2 10 / 6 17 95 45  
info@haefe.gr

Hungary

Häfele GmbH & Co KG  
Representative in Hungary  
1132 Budapest  
Phone +36 (0)1 / 2 25 34 14  
Fax +36 (0)1 / 2 02 01 82  
info-hungary@haefe.com

Ireland

Häfele Ireland Ltd.  
Kilcoole, Co. Wicklow  
Phone +3 53 (0)1 / 2 87 34 88  
Fax +3 53 (0)1 / 2 87 35 63  
info@haefe.ie

Italy

Häfele Italia s.r.l.  
20030 Lentate S.S. -MI-  
Phone +39 03 62 / 57 74-1  
Fax +39 03 62 / 57 74-4 77  
info@haefe.it

Netherlands

Häfele Nederland BV  
7333 NZ Apeldoorn  
Phone +31 (0)55 / 5 38 46 00  
Fax +31 (0)55 / 5 42 49 50  
info@haefe.nl

Poland

Häfele Polska Sp. z o.o.  
55-090 Dlugoleka  
Phone +48 (0)71 / 3 15 32 42  
Fax +48 (0)71 / 3 15 32 62  
info@haefe.pl

Portugal

Häfele GmbH & Co KG  
Escritorio de Vendas Portugal  
4470-177 Maia  
Phone +3 51 (0)22 / 9 47 55 96  
Fax +3 51 (0)22 / 9 48 15 74  
info-portugal@haefe.com

Romania

Häfele GmbH & Co KG  
Reprezentanta în România  
RO-500264 Brasov  
Phone +40 (0)2 68 / 31 19 00  
Fax +40 (0)2 68 / 31 19 10  
info@haefe.ro

Russia

OOO Hafele RUS  
Mkad 14Km, Building 10  
109429 Moscow  
Phone +7 (495)7 87 / 07 85  
Fax +7 (495)7 87 / 07 84  
info@haefe.ru

Serbia

Häfele GmbH & Co KG  
Representative in Serbien  
37000 Krusevac  
Phone +3 81 37 / 41 70 10  
Fax +3 81 37 / 41 70 10  
info-serbia@haefe.com

Spain

Häfele Herrajes España S.L.  
28923 Alcorcón-Madrid  
Phone +34 91 / 6 44 80 21  
Fax +34 91 / 6 44 80 28  
info@haefe.es

Sweden

Häfele GmbH & Co KG  
Tyskland Fällial Sverige  
55303 Jönköping  
Phone +46 (0)46 36 / 18 00 88  
Fax +46 (0)46 36 / 18 00 99  
info@haefe.se

Switzerland

Häfele Schweiz AG  
8280 Kreuzlingen  
Phone +41 (0)71 / 6 86 82 20  
Fax +41 (0)71 / 6 86 82 82  
info@haefe.ch

Turkey

Hafele San. ve Tic. A.S.  
34776, Ümraniye, Istanbul  
Phone +90 (0)2 16 / 5 28 59 00  
Fax +90 (0)2 16 / 5 28 59 30  
info@haefe.com.tr

Ukraine

Häfele GmbH & Co KG  
Representative in Ukraine  
79017 LVIV  
Phone +3 80 32 2 75-35-61  
Fax +3 80 32 2 75-35-61  
info-ukraine@haefe.com

Africa

South Africa

Häfele South Africa (Pty) Ltd  
Honeydew 2040  
Phone +27 (0)11 / 7 96 81 00  
Fax +27 (0)11 / 7 94 14 90  
info@haefe.co.za

America

Argentina

Häfele Argentina S.A.  
B1611GFG-Don Torcuato-Buenos Aires  
Phone +54 (0)11 / 63 47 26 00  
Fax +54 (0)11 / 63 47 26 26  
info@haefe.com.ar

Brazil

Häfele Brasil Ltda.  
06465-120 Barueri-SP  
Phone +55 (0)11 / 41 96 69 00  
Fax +55 (0)11 / 41 96 69 09  
info@haefe.com.br

Canada

Häfele Canada Inc.  
Burlington, ON L7L 6A8  
Phone +1 9 05 / 3 36 66 08  
Fax +1 9 05 / 3 19 44 46  
info\_can@hafeleamericas.com

Chile

Häfele GmbH & Co KG  
Agencia en Chile  
Las Condes - Santiago de Chile  
Phone +56 (0)2 / 3 56 43 63  
Fax +56 (0)2 / 3 56 45 40  
info@haefe.cl

Mexico

Häfele de México S.A. de C.V.  
El Marqués, Querétaro, México.  
Phone +52 (0)4 42 / 296 86 00  
Fax +52 (0)4 42 / 296 86 20  
hmxinfomexico@haefe.com.mx

United States of America

Häfele America Co  
Archdale, N.C. 27263  
Phone +1 3 36 / 4 34 23 22  
Fax +1 3 36 / 4 31 38 31  
info\_us@hafeleamericas.com

Australia, New Zealand

Australia

Häfele Australia Pty. Ltd.  
Dandenong, VIC 3175  
Phone +61 (0)3 / 92 12 20 00  
Fax +61 (0)3 / 92 12 20 01  
info@haefe.com.au

New Zealand

Häfele (N.Z.) Limited  
East Tamaki, Auckland  
Phone +64 (0)9 / 2 74 20 40  
Fax +64 (0)9 / 2 74 20 41  
info@haefe.co.nz

Middle East

Dubai

Häfele GmbH & Co KG  
Dubai Representative Office  
Dubai/U.A.E.  
Phone +9 71 (0)4 / 2 84 44 06  
Fax +9 71 (0)4 / 2 86 08 49  
info@haefe.ae

Far East

China

Häfele Hardware Technology  
(Beijing) Co., Ltd.  
101318 Beijing  
Phone +86 (0)10 / 80 48 26 86  
Fax +86 (0)10 / 80 48 28 85  
info\_bj@haefe.com.cn

Hong Kong

Häfele GmbH & Co KG  
HK Representative Office  
Hong Kong  
Phone +8 52 / 23 68 64 33  
Fax +8 52 / 23 68 99 72  
info\_hk@haefe.com.cn

India

Häfele India Private Limited  
Mumbai 400 099  
Phone +91 (0)22 / 66 95 09 20/21  
Fax +91 (0)22 / 66 95 09 22  
info@hafeleindia.com

Indonesia

P.T. Häfele Indotama  
Tangerang 15314  
Phone +62 (0)21 / 75 87 88 88  
Fax +62 (0)21 / 75 87 77 77  
info@haefe.co.id

Japan

Hafele Japan K.K.  
Totsuka-ku, Yokohama 244-0806  
Phone +81 (0)45 / 8 28 31 17  
Fax +81 (0)45 / 8 28 31 13  
info@haefe.co.jp

Malaysia

Häfele (Malaysia) Sdn Bhd  
40150 Shah Alam, Selangor  
Phone +60 (0)3 / 55 69 25 26  
Fax +60 (0)3 / 55 69 35 26  
info@haefe.com.my

Philippines

Häfele Philippines Inc.  
Manggahan Pasig City 1611  
Metro Manila  
Phone +63 (0)2 / 6 81 53 52  
Fax +63 (0)2 / 6 81 53 41  
info@haefe.com.ph

Singapore

Häfele Singapore Pte Ltd  
Singapore 729504  
Phone +65 / 64 94 74 00  
Fax +65 / 64 94 74 01  
info@haefe.com.sg

South Korea

Häfele Korea Inc.  
659 Jinu-ri, Dochuk-myon,  
Gwangju-si, Gyeonggi-do  
Phone +82 (0)31 / 7 60 76 00  
Fax +82 (0)31 / 7 60 76 09  
info@haefe.co.kr

Taiwan

Häfele Taiwan Ltd.  
Taipei County 248, Taiwan (R.O.C.)  
Phone +8 86 (0)2 / 22 98 00 30  
Fax +8 86 (0)2 / 22 98 00 31  
info@haefe.com.tw

Thailand

Häfele (Thailand) Limited  
57 Soi Sukhumvit 64  
Bangkok 10260  
Phone +66 (0)2 / 7 41 71 71  
Fax +66 (0)2 / 7 41 72 72  
info@haefe.co.th

Vietnam

Hafele Vina Co., Ltd.  
Ho Chi Minh City  
Phone +84 (0)8 / 39 57 31 66  
Fax +84 (0)8 / 39 57 31 67  
info@haefe.com.vn